



Paulmann

Safety Instructions

1, 2, 3, 4, 7, 9, 11, 12, 13, 14, 16, 17, 18, 19, 21, 33, 34



31.08.2021

01.09.2021

ENERGY LABEL 874/2012

ENERGY LABEL 2019/2015

A++ - A

G



www.paulmann.com/symbols

Paulmann Licht GmbH
Quezinger Feld 2
31832 Springe
Germany

www.paulmann.com

Art.-Nr. : 709.62



(+326)PPN 07/22

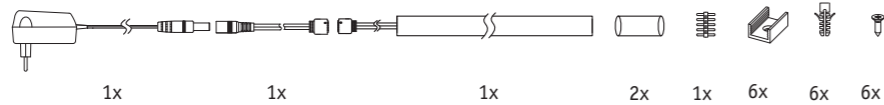

A1 A2

Safety Instructions
Nr. 7, 10

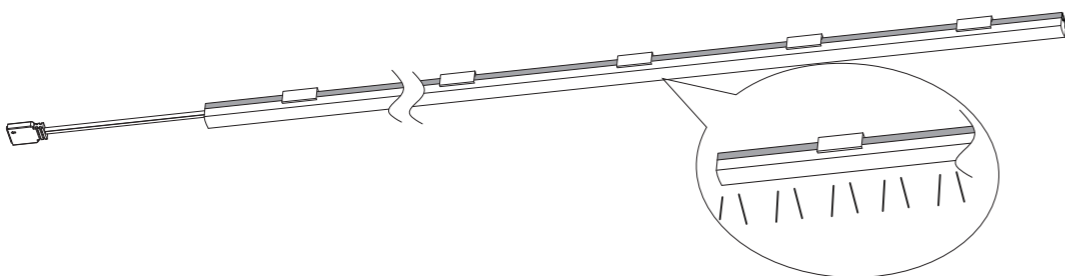
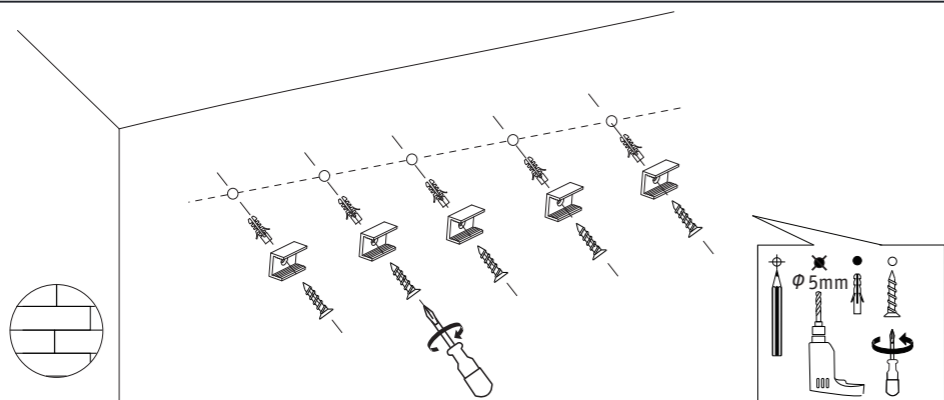

A1 A2

Safety Instructions
Nr. 7, 10

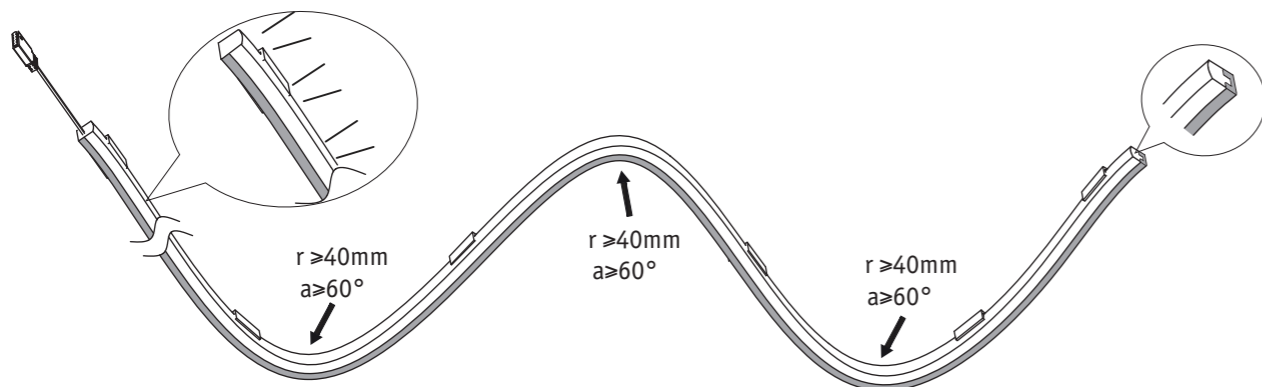
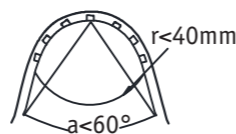
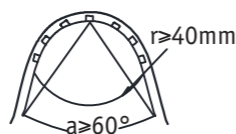
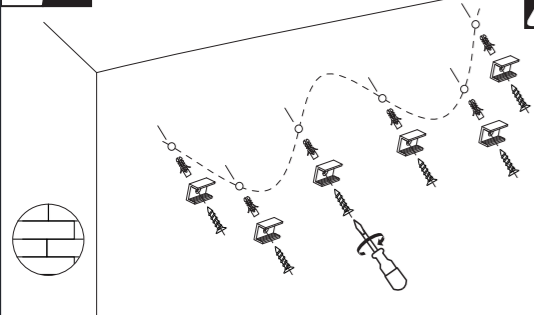

B

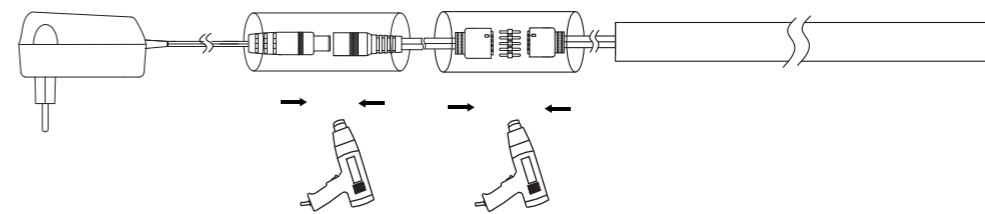

IP20

IP44

IP67

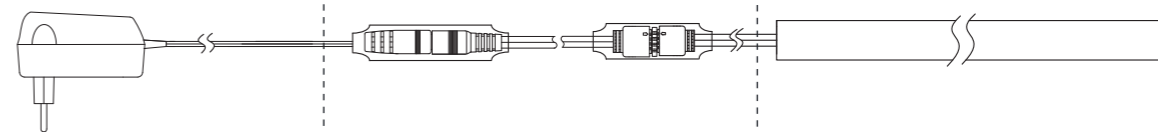

Off



On

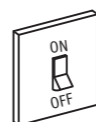

On



Mark the cutting edge on the backsight



Off



Cuttable every 3,3cm



On

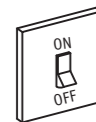

IP20

